

Data Sheet

K3

BIZERBA

Optimize operating procedures, selling processes and interaction with the customer with your individual K3 solution. The multi-touch display with new GUI allows easy and intuitive operation. The modular concept and smart IoT technologies set new industry standards. Remain flexible for the long-term with your K3 solution and benefit from maximum investment reliability.



More information
High performance
with a wide range of
solutions and options.

Product description

The intelligent modular concept opens up a multitude of new possibilities for you, your operating personnel and your customers: The K3 is perfectly suitable for assisted sales, self-service and price labeling – and furthermore ideally suitable as an interface for orders via Online Store or info terminal.

The K3 can be smoothly networked with other systems such as with slicers. Thanks to the Plug&Play function, displays can be easily exchanged. Innovative Hot Swap technology allows printer change in the twinkling of an eye, even during running operation. The printers of the K3 stand out in terms of their robustness, longevity and not least through their unique linerless printer unit with cutter technology with an impressive service life of more than 500,000 cuts.

In combination with the capacitive multi-touch technology the unique ergonomic GUI allows highest operating convenience and optimized customer interaction. Swiping and Drag&Drop function simplify the adjustment of the keyboard layout as well as fast call-up of frequently used functions. Increase customer interaction with the touch screen customer display: Have recipes matching the bought product displayed, for example, or offer the opportunity of direct feedback.

Also benefit from maximum transparency and optimal service: Installed IoT sensors and the management software RetailControl allow constant monitoring of various components. Handling recommendations and service intervals can be specifically planned.



K3 800



K3 100

Highlights

Premium & flexibility

- Modern, state-of-the-art design which integrates in any store concept
- Modular expansion of system and software as needed and based on use:
 - Hot Swap: Fast printer replacement during running operation
 - Plug&Play: Easy replacement of operator and customer display

Performance

- Very easy to operate & optimal creation of operating processes:
 - Clear, uniform and ergonomically designed user interface
 - Easy operation due to capacitive multi-touch technology of the displays
 - Increased interaction and involvement of the customer in the sales process through multi-touch on the customer display
- New standard in the linerless printer unit with cutter technology:
 - High service life: More than 500,000 cuts
 - Less roll changes due to larger linerless rolls: up to Ø 150 mm (K3 100)

Monitoring & Service

- Monitoring of the load cell via IoT sensors: Conclusions on the condition of the components (e.g. number of weighing or cuts of the cutter)
- Remote support: Supported, remote-controlled printer and display exchange or GUI adjustment



K3 Flex

Options

- Precise multi-interval scale: Multiple subdivision of measuring range (3/6/15 kg, 1/2/5 g)

My Bizerba

We offer you solutions from a single source which can be customized and allow you to respond to any change in a flexible manner. Benefit from costs which can be planned and efficient processes. We are happy to advise you.

Bizerba SE & Co. KG

Wilhelm-Kraut-Straße 65
72336 Balingen

T +49 7433 12-0
fax: +49 7433 12-2696
marketing@bizerba.com

www.bizerba.com

Fact Sheet

K3

BIZERBA

Optimize operating procedures, selling processes and interaction with the customer with your individual K3 solution. The multi-touch display with new GUI allows easy and intuitive operation. The modular concept and smart IoT technologies set new industry standards. Remain flexible for the long-term with your K3 solution and benefit from maximum investment reliability.



More information
High performance
with a wide range of
solutions and options.

Specifications	Facts	Details
Variants	<p>K3 100 - Counter top scale (optional: counter top scale with remote/ raised display)</p> <p>K3 800 - Counter scale or self-service scale</p> <p>K3 400 - Hanging scale</p> <p>K3 Flex - Separate version</p>	<p>Operator display: 12.1"</p> <p>Customer display: Without/7"/12.1"</p> <p>Operator display: 12.1"/15.6"</p> <p>Customer display: Without/7"/12.1"/15.6"</p> <p>Operator display: 12.1"/15.6"</p> <p>Customer display: Without/7"/12.1"/15.6"</p> <p>Operator display: 12.1"/15.6"</p> <p>Customer display: Without/7"/12.1"/15.6"</p>
Color	<p>Column silver-gray, powder-coated casting</p> <p>Displays, printer and basic module signal black</p>	RAL 9004
Operating system	<p>Windows® 10 IoT Enterprise 2019 LTSC</p> <p>Linux OpenSuse® Leap ≥15.1 64 bit Kernel 4.12</p>	<p>64 bit Windows</p> <p>64 bit Linux</p>
Device software	<p>RetailStore</p> <p>RetailBridge</p>	<p>Bizerba device software</p> <p>3rd-party software</p>
Processor	<p>Intel® Atom x5 processor E3940</p> <p>Quad Core</p>	<p>Clock rate of up to 1.80 GHz</p> <p>L2 cache: 2 MB</p> <p>Instruction set: 64 bit</p> <p>Integrated graphics card: Intel® HD Graphics 500</p> <p>Fanless cooled</p>
Working memory	DDR3L RAM	4 GB, optionally 8 GB
Mass memory	SSD	64 GB, optionally 128 GB
Operator display	<p>12.1" TFT display with PCAP (capacitive) touch screen</p> <p>15.6" TFT display with PCAP (capacitive) touch screen</p>	<p>Resolution: 1,280 x 800 (16:10), WXGA</p> <p>Resolution: 1,366 x 768 (16:9), HD Wide</p> <p>LED backlighting, antireflective glass surface</p> <p>Infinitely adjustable viewing angle</p>
Customer display	<p>7" TFT display</p> <p>12.1" TFT display</p> <p>15.6" TFT display</p> <p>All optional with PCAP (capacitive) touch screen</p>	<p>Resolution: 800 x 480 (5:3), WVGA</p> <p>Resolution: 1,280 x 800 (16:10), WXGA</p> <p>Resolution: 1,366 x 768 (16:9), HD Wide</p> <p>LED backlighting, antireflective glass surface</p> <p>Optional: Infinitely adjustable viewing angle</p>

Printer	3" receipt/linerless printer with auto-cutter 3" receipt/label printer For 800 model optionally two printers: 3" receipt/linerless printer with auto-cutter + 3" receipt/label printer	Paper roll width: 37-80 mm, flexibly adjustable Print width: 78 mm Print resolution: 8 dots/mm (203 dpi) Roll diameter: – Model K3 800: Max. 105 mm – Model K3 100: Max. 150 mm Print speed: Max. 250 mm/s depending on paper used Linerless auto-cutter properties (depending on linerless quality & amount of adhesive) Service life: More than 500,000 cuts without lubricants
Interfaces	1 x USB 3.0 type A 3 x USB 2.0 type A LAN 1 x RJ12	Super speed High speed Ethernet RJ45 10/100/1,000 MBit/s For connection to cash register drawer
Weighing ranges	Model without scale function 3/6 kg 6/15 kg 3/6/15 kg 15/30 kg 15/30 lb 30 lb 60 lb 30/60 lb Easy Level tilt compensation	No weighing function Scale interval 1/2 g, minimum load 20 g Scale interval 2/5 g, minimum load 40 g Scale interval 1/2/5 g, minimum load 20 g Scale interval 5/10 g, minimum load 100 g Scale interval 0.005/0.01 lb, minimum load 0.1 lb Scale interval 0.01 lb, minimum load 0.2 lb Scale interval 0.02 lb, minimum load 0.04 lb Scale interval 0.01/0.02 lb, minimum load 0.10 lb Automatic correction of incorrect weight values due to scale's angled position of up to 2°
Temperature range & humidity	-10 °C to +40 °C Max. 90 %	Operating temperature Relative humidity
Power consumption	Voltage: 120 - 240 V, 47/63 Hz Operation (12.1" operator display / 7" customer display): ≤ 33 W Stand-by: ≤ 1.5 W	Performance depending on configuration Energy saving with Wake on LAN (WoL)
Net weight of device	17 kg (model K3 100 with 12.1"/12.1") 21 kg (model K3 800 with 15.6"/15.6")	Weight depending on configuration

Options	Facts	Details
Software extensions	RetailApps Software modules: Cash register, scanning, e-cash, inventory, delivery note, proof of origin, time registration, video journal, Retail-Connect Management software RetailControl	Extra software function per RetailApps Extra software functions per module Additional software in order to track and manage devices, data and updates

Security	UEFI BIOS with Secure Boot	
	WoL FUNCTIONALITY	Wake on Lan
	Remote Disaster Recovery mode	
	Password protected menu access	
Monitoring	Monitoring static and dynamic values of various components	E.g. number of cuts, voltage drops of the CPU, operating hours counter for display backlighting etc.
Connection of external components	Connection external additional printer	With other paper type/other label layout
	Connection cash register drawer	RJ12, connection of up to two cash register drawers with adapter possible

Infografik



Dimensional drawings

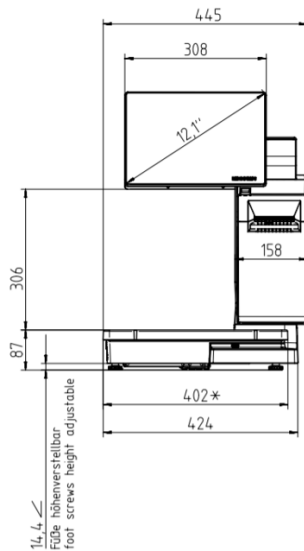

K3 800 -12.1" operator display

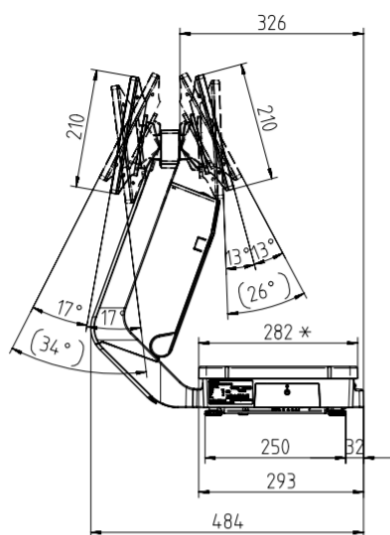

K3 800 - side view

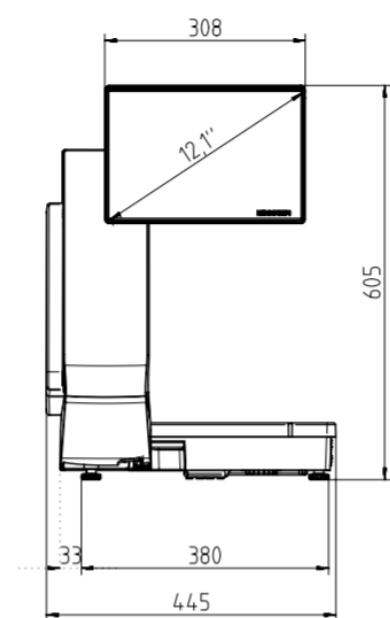

K3 800 - 12.1" customer display

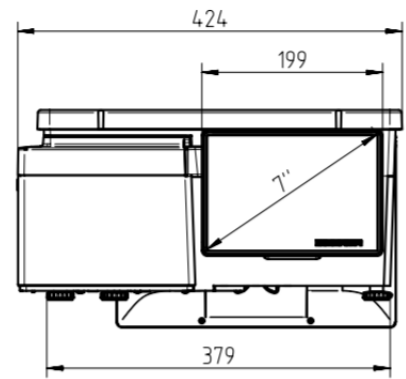
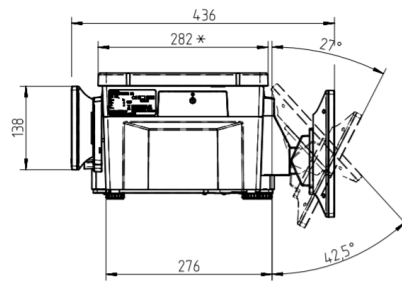
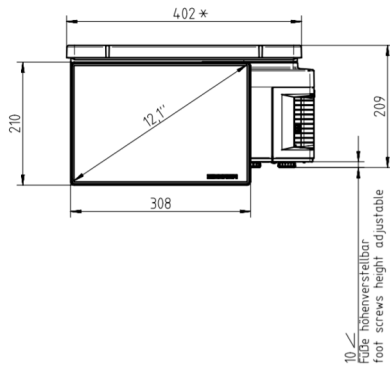

K3 100 - 12.1" operator display

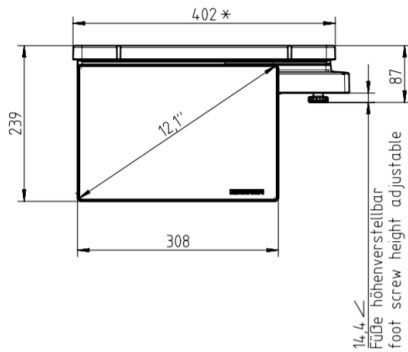

K3 100 - side view

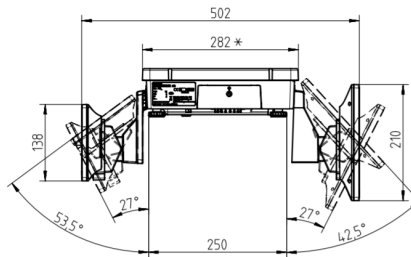

K3 100 - 7" customer display

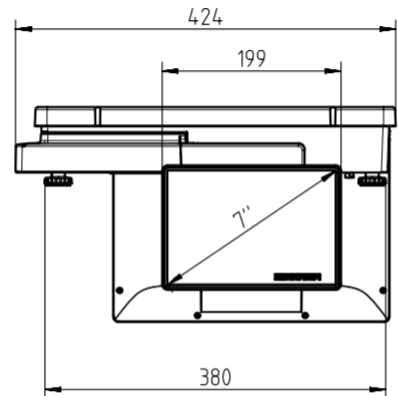

K3 100 flat - 12.1" operator display

K3 100 flat - side view

K3 100 flat - 7" customer display

Bizerba SE & Co. KG
Wilhelm-Kraut-Straße 65
72336 Balingen

T +49 7433 12-0
fax: +49 7433 12-2696
marketing@bizerba.com

www.bizerba.com